



SA420 Digital Signal Conditioner

- Easy field-adjustable calibration
- 4-20 mA and 0-10 Vdc outputs
- Accepts wide range of input frequencies 0.01 Hz to 10 KHz
- Interfaces with a wide variety of sensors
- ETL® approved to applicable UL and CSA standards
- DIN rail mount module
- 5-Year Limited warranty on speed switches, sensors & ratemeters*

* Contact factory for more information

Product Information

Description

Electro-Sensors' SA420 Digital Signal Conditioner provides an analog signal directly proportional to the speed of a rotating shaft. The 0-10 Vdc and 4-20mA output signals can be sent to a digital display, PLC, chart recorder, loop controller, drive speed controller or other control/monitoring device. The wide voltage range and wave shape flexibility of the SA420's sensor input circuitry enables it to translate input signals from Hall Effect sensors, proximity switches, magnetic sensors, and a wide variety of other pulse generator devices, into analog outputs. The standard SA420 system includes the SA420 DIN rail mount module, a 906 sensing Head and a 255 Pulser Disc. Electro-Sensors' products bring efficiency and safety to your operations by preventing machine damage, product waste and costly downtime.

Dimensional Drawings • SA420 Digital Signal Conditioner

SA420 Module

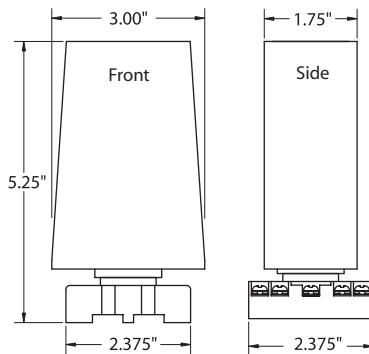

Terminal Block

Stock No. 569-006100

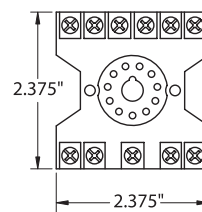

907 Explosionproof Sensor

Stock No. 775-000600

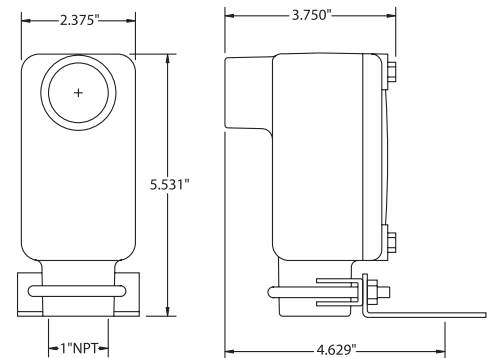

906 Digital Sensor

Stock No. 775-000500

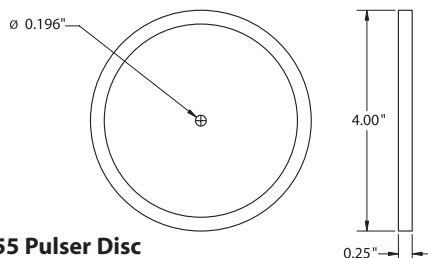
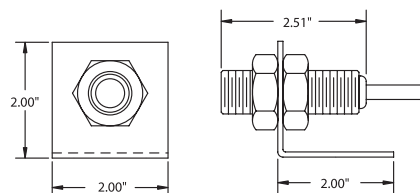

255 Pulser Disc

Stock No. 700-000200

