

- Heavy Duty Sensing Probe
- DPDT 10 Amp Relay
- Optional 230 VAC Operation
- Control Unit Remotely Mounted
- Fail-Safe Operation



Description

The Electro-Sensors VUM-800 Vibration Monitor confirms normal operation of processes utilizing continuous vibration. Since the VUM-800 measures actual vibration not motor rotation, power draw or any other implied measures, all sources of failure are detected: Power loss, motor or gearbox failure, belt slippage or breakage. Applications include shaker screens, vibratory feeders, bin bottoms and crushers. The solid state electronics of the VUM-800 probe are epoxy encapsulated inside a metal enclosure, making it rugged and reliable. The VUM-800 is easily installed and needs no calibration or maintenance. The unit is fail-safe; power loss or a broken cable will indicate an alarm situation.

Principle of Operation

The VUM-800 consists of the sensing probe which is mounted on the vibrating equipment, a cable, and the relay control which is mounted remotely. Low voltage (24 VAC) is sent from the control unit to the probe. When the probe is vibrating with a force of 2g's a mercury switch inside the probe is activated and contact is made, this sending current back to the control unit and energizing the relay. This is the normal mode of operating condition. The mercury switch will break the circuit if there is no vibration.

Dimensional Drawings - VUM-800

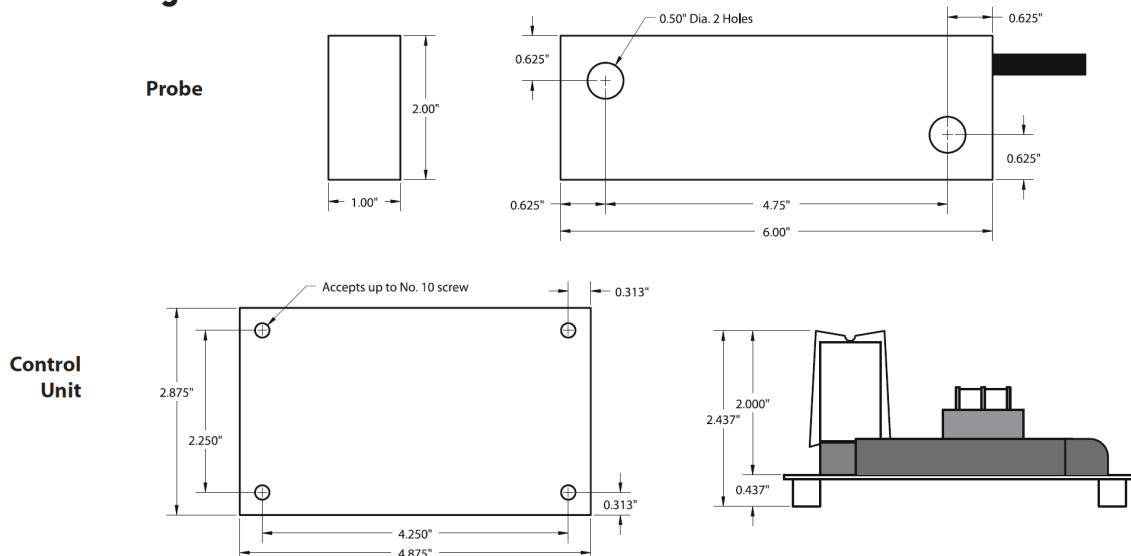

Product Specifications

VUM-800 Specifications	
Dimensions (Sensor Block)	1in X 2in X 6in
Dimensions (Controller)	2.875in X 4.875in X 2.437in
Power	
Voltage	115 Vac +/- 10%, 50-60 Hz @ 30mA 230 Vac Optional +/- 10%, 50-60Hz (Factory Set with Jumpers)
Output voltage to probe	+24 Vac 10%, unfiltered, @ 10mA 230 Vac Optional +/- 10% with relay de-ener- gized + 8.5 Vac +/- 10%, Unfiltered, @ 50 mA +/-10% with relay energized.
Relay contacts	DPDT 10 Amp @ 120 Vac Resistive 0° C to +55° C
Terminal Strips	Capacitive wire-clamping plate screw rated 10 Amp @ 150 V
Cable	2-conductor 16 AWG Un- shielded
Cable Length	8 Ft. Standard
Activation Force	2 G's

Specifications subject to change without notice.

Installation Instructions

The sensing probe is installed on the most critical vibrating part of the equipment to be monitored. The probe must be mounted within 15 degrees of horizontal. Two 1/2" holes in the probe are provided for easy installation on equipment. The control unit can be installed up to 500 feet from the probe. Where severe vibration is encountered, a cable splice close to the probe is recommended, so possible cable breakage may be repaired without loss of the probe.

Ordering

Model Number	Part Number
VUM-800 115 VAC	800-008900
VUM-800 230 VAC	800-008901

Control Unit Wiring Diagram

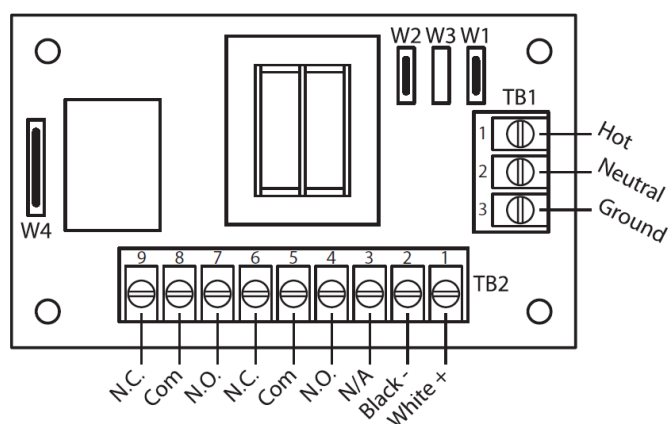

Typical Wiring Diagram

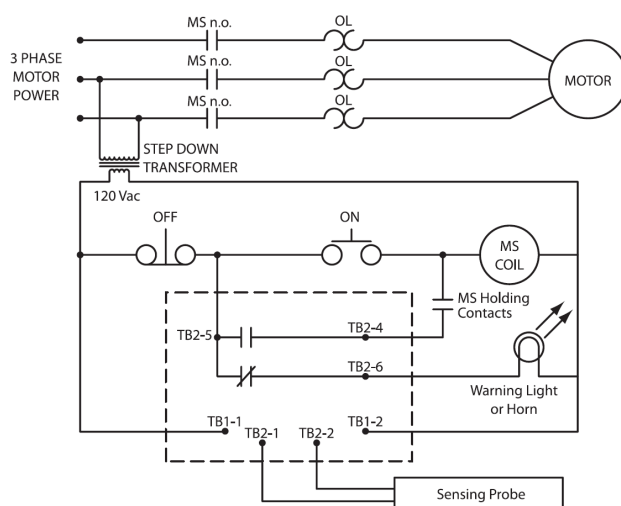

Customization

If one of our standard products does not meet your specifications, please call one of our applications specialists. Many of our products can be customized to fit specific needs.

Additional Information

For more information about product, please refer to the VUM-800 Installation and Operating Manual.

Email: sales@electro-sensors.com

Tel: (800)328-6170

Fax: (952)930-0130

We also have more information online at:
www.electro-sensors.com